

**SIDE VIEW**

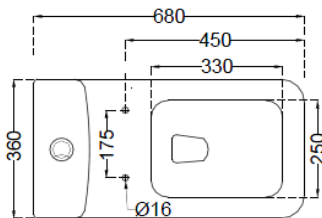

**TOP VIEW**

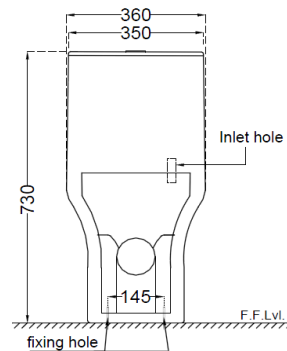

**BACK VIEW**

**General Information**

Product Code	AIS-WHT-101853S300SPPSM
Brand	Essco
Colour	White
Type	S-Trap 300 mm
Material	Ceramic-Vitreous China (VC)

**Product Specification**

Product Dimension	360x680x730 mm
Bowl Opening (Inner Dimension)	250x330 mm
Product Net Weight	49 kg
Product Gross Weight	55 kg
Packaging Dimension	680x360x730
Outlet	Vertical
Trap Distance	S Trap - 300 mm
Outlet Hole Dimension	External diameter of outlet hole dia. $\varnothing 100 \pm 5$ mm
	Horizontal distance between the wall line and the centre line of the waste outlet hole $\leq 300$ mm

Product Features	<p>Sleek And Stylish Design With Rectangular Shape</p> <p>PP Slim Soft Close Seat Cover</p> <p>Water Usage - 3/6 LPF With Wash Down Flushing</p> <p>Anti Bacterial Glaze on Ceramic</p> <p>Smooth Glaze Surface</p> <p>Material - Vitreous China (VC)</p> <p>Product With Complete Genuine Accessories</p> <p>Complete Trap Wash</p> <p>Rimless Design</p>
------------------	--

**ACCESSORIES PROVIDED**

PP Soft Close Slim Seat Cover	AIS-WHT-103S
Floor fixing screw	ZPS-SNS-FB01
Cistern Fittings	ZCF-WHT-FT002
Wax Seal	ZPS-WHT-1401

**QUALITY MANAGEMENT SYSTEM - ISO 9001** 

**DISCLAIMER:** Our every effort has been made to ensure factual accuracy, the information presented subject to changes due to requirements in different sites, markets and/ or countries. All dimensions are in mm (Tolerance  $\pm 5$  MM). Jaquar reserves the right to make the necessary amendments at any time without prior notice.